

# wirata®

## INSTRUCTION MANUAL

Model No.:

**TF-180**

Please read *Instruction Manual* before use  
& Follow ALL the instructions carefully.

<b>MODEL NO.</b>	<b>TF-180</b>
POWER	60W
VOLTAGE	220-240V
FAN SIZE	18" (450mm)
FREQUENCY	50-60Hz
NO. OF BLADE	5
FAN SPEED	3

## WHAT'S IN THE BOX

1. Table Fan – 1set
2. Instruction Manual- 1 set

## PARTS DESCRIPTION

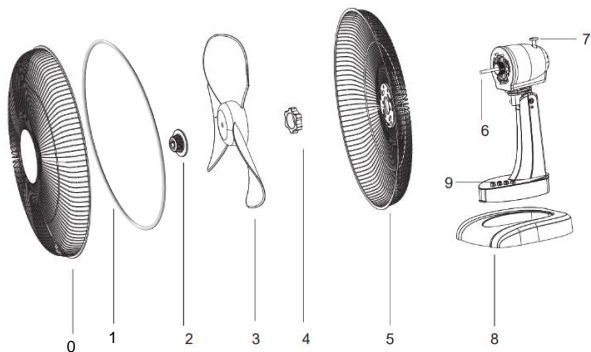

### MAIN COMPONENT :

(Product may vary slightly from what is illustrated)

0: Guard ring

1: Front guard

2: Fan blade nut

3: Blade

4: Blade lock

5: Rear guard

6: Motor shaft

7: Oscillation knob

8: Base

9: Control panel

## GENERAL INSTRUCTION

When using the electrical appliance, the following basic safety precautions should always be followed.

Please read these instructions carefully. Pay your special attention to important safety instructions. Keep this "**Instructions for use**" for future reference.

## SAFETY INSTRUCTIONS

**WARNING** - To reduce the risk of fire, electric shock or injury to persons or property:

1. Always operate the product from a power source of the same voltage, frequency and rating as indicated on the product identification plate.
2. Do not use this fan with any solid-state speed control device to reduce the risk of electric shock.
3. The appliance is not intended for use by persons (including children) with reduced physical, sensory, mental capabilities or lack of experience and knowledge, unless they have been given supervision or instructions concerning use of the appliance by a person responsible by their safety.
4. Children should be supervised to ensure that they do not play with the appliance.
5. Do not leave the fan running unattended.
6. Do not operate the product if it is dropped, damaged or showing signs of product malfunction. Do not operate the product with a damaged plug or cord. Return the complete product to the place of purchase for inspection, refund or replacement.
7. If it is not working properly, contact a qualified electrician or service centre for examination and repair, never try to dismantle it by yourself.

8. Do not immerse or expose the product or flexible cord to rain, moisture or any other liquid.
9. This product should not be used in the immediate vicinity of water, such as bathtubs, washbowls, swimming pools etc. where the likelihood of immersion or splashing could occur.
10. Never install the unit where it could be subject to:
  - Heat sources such as radiators, heat registers, stoves or other products that produce heat
  - Direct sunlight
  - Mechanical vibration or shock
  - Excessive dust
  - Lack of ventilation, such as a cabinet or bookcase
  - Uneven surface
11. Switch off and unplug from outlet when the product is not in use, before assembling or disassembling parts and before cleaning. Fully assemble the fan before switching on.
12. Avoid contact with moving parts. Do not insert any body parts (e.g., finger) or objects through the grill when the fan is operating.
13. Do not cover the grille, or operate in close proximity to curtains, etc.
14. This product is intended for normal domestic/household use only.
15. Always disconnect the fan when moving it from one location to another.
16. The use of attachments or accessories not recommended or sold by the product distributor may cause personal or property hazards or injuries.
17. Be sure fan is on a stable surface when operating to avoid overturning.
18. Do not immerse in water.
19. If the supply cord is damaged, it must be replaced by the manufacturer or its service agent, or similarly qualified person, in order to avoid a hazard.

**WARNING:** Do not use the device near water, over the bath tub, pool or other water basin.

\*Observe the above-mentioned rules in order to avoid burning, electric shock or fire hazard. Make sure you understand the instructions.



## ASSEMBLY INSTRUCTION

1. To assemble the safety grille and blade assembly, remove the spinner (by turning it clockwise), then the locking nut (by turning it anticlockwise) from the motor spindle.
2. Place the back safety grille into position. Ensure the safety grille fits into the locating lugs. If this is done correctly, the safety grille's carry handle will be at the top.
3. Fix the safety grille into position by replacing the locking nut tightly by hand. Do not force the locking nut.
4. The groove in the centre of the fan blade aligns with a T-bar on the motor spindle to ensure correct positioning.
5. Fix the blade into place by gently hand tightening the spinner anticlockwise onto the end of the motor spindle. The spinner is self-tightening do not force it.
6. Lift out all locking clips on the front safety grille.
7. Place the safety grille into position and secure it by fastening the clips over the outer rim. The screw and nut at the bottom of the grille must be fixed.

## HOW TO OPERATE

1. Select a suitable location for the fan. Always choose a safe location in accordance to the safety recommendations outlined.
2. To make/stop the fan head oscillate, push down/pull the clutch knob.

3. To adjust the airflow upward or mild downward, simply loosen the Swivel Adjustment Knob and move to desired angle then firmly tighten the Swivel Adjustment Knob.
4. Speed is controlled by depressing the piano keys.
5. **ON/ OFF and Speed control:** -  
The ON/Off and Speed is controlled by the push button.
  - 0-The Fan is switched Off
  - 1-at the lowest speed
  - 2-at the middle speed
  - 3-at the highest speed
6. Plug the power supply cord into a wall outlet
7. Angle Adjustment. Switch off the fan. Adjust the fan to the desired angle by hand.

### CLEANING INSTRUCTION

1. Be sure to unplug from the electrical supply source before cleaning.
2. Plastic parts should be cleaned with mild soap and a damp cloth or sponge. Thoroughly to remove soap film with clean water.
3. Be sure not to make water or other liquid enter inside of motor.

**CAUTION:** Do not use harsh detergents, chemical cleaners or solvents as they may damage the surface finish of the fan components.



#### ENVIRONMENT PROTECTION

Dispose the appliance according to the local garbage regulations. Never throw it away to the rubbish, so you will help to the improvement of the environment.