

wirata®

INSTRUCTION MANUAL

Model No.:

JK-253

Please read *Instruction Manual* before use
& Follow ALL the instructions carefully.

MODEL NO.	JK-253
Power Consumption	1850-2200W
Voltage	220-240V
Frequency	50/60Hz
Volume Capacity	1.7L

WHAT'S IN THE BOX

1. Glass Kettle – 1pc
2. Power cord – 1pc
3. Instruction Manual – 1pc

PARTS DESCRIPTION



MAIN COMPONENT :

(Product may vary slightly from what is illustrated)

- | | |
|--------------------------|-----------------------|
| 1: Top lid | 6: Lid release button |
| 2: Spout/Pourer | 7: On/off switch |
| 3: Filter | 8: Handle |
| 4: Water level indicator | 9: Power base |
| 5: LED power indicator | |

GENERAL INSTRUCTIONS

When using the electrical appliance, the following basic safety precautions should always be followed.

Please read these instructions carefully. Pay your special attention to important safety instructions. Keep this **"Instructions for use"** for future reference.

SAFETY INSTRUCTIONS

1. Always remove the plug from the socket whenever the device is not in use, when attaching accessory parts, cleaning the device or whenever a disturbance occurs, Switch off the device beforehand. Pull on the plug, not on the cable.
2. In order to protect children from the dangers of electrical appliances, never leave them unsupervised with the device. Consequently, when selecting the location for your device, do so in such a way that children do not have access to the device. Take care to ensure that the cable does not hang down.
3. This appliance cannot be used by the persons (including children) with reduced physical, sensory or mental capabilities, or lack of experience and knowledge, unless they have been given supervision or instruction by the person who responsible for their safety. Children should be supervised to keep away from this appliance and forbid to play with it.
4. Test the device and the cable regularly for damage. If there is damage of any kind, the device should not be used.
5. Do not repair the device yourself, but rather consult an authorised expert.

6. For safety reasons a broken or damaged mains lead may only be replaced by an equivalent lead from the manufacturer, our customer service department or a similarly qualified person.
7. Keep the device and the cable away from heat, direct sunlight, moisture, sharp edges and suchlike.
8. Never use the device unsupervised. Switch off the device whenever you are not using it, even if this is only for a moment.
9. Use only original accessories.
10. Do not use the device outdoors.
11. Under no circumstances must the device be placed in water or other liquid, or come into contact with such. Do not use the device with wet or moist hands.
12. Should the device become moist or wet, remove the mains plug from the socket immediately.
13. Do not reach into the water.
14. Use the device only for the intended purpose.
15. This appliance is not intended use by persons (including children) with reduced physical, sensory or mental capabilities, or instruction concerning use of the appliance by a person responsible for their safety.
16. Children should be supervised to ensure that they do not play with the appliance.
17. The kettle is only to be used with the stand provided.

WARNING: If the kettle is overfilled, boiling water may be ejected.

* If the supply cord is damaged, it must be replaced by the manufacturer, its service agent or similarly qualified persons in order to avoid a hazard.

PRECAUTION

1. Use only cold water when filling.
2. The water level must be between the MAX. and MIN. marks
3. Switch the machine off before removing it from the base.
4. Always ensure that the lid is tightly closed.
5. The base and exterior of the machine must not become wet
6. The kettle body used must be match with the kettle base.

HOW TO OPERATE

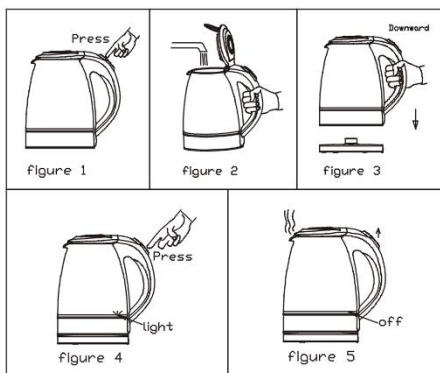

Before using the machine for the first-time water should be boiled in it twice without any additives.

1. Fill the kettle with water. Do not overfill Use the water level indicator.
2. Place the kettle flush on the base.

3. Electrical connection

- Check whether the electrical voltage that you intend to use is the same as that of the machine. Details are to be found on the label on the base.
- Only connect the machine to a properly installed 220-240V 50/60Hz safety socket.

4. Switch the machine to position "1". The control lamp on the water level indicator shows that the water is being boiled.

5. After boiling the machine switches off automatically.

Disconnect the machine from the mains electricity supply.

Do not press up the lid when pouring.

6. This appliance is intended to be used in household and similar applications such as:

- Staff kitchen areas in shops, offices and other working environments, farm houses;
- By clients in hotels, motels and other residential type environments
- Bed and breakfast type environments.

CLEANING INSTRUCTION

Always remove the plug from the mains supply before cleaning the machine.

1. The exterior of the machine should be cleaned, if necessary, with a slightly damp cloth without additives.
2. The calcium filter can be removed for cleaning.
3. Power supply: 220-240V - 50/60Hz 1850-2200W



ENVIRONMENT PROTECTION

Dispose the appliance according to the local garbage regulations.

Never throw it away to the rubbish, so you will help to the improvement of the environment.