

# wirata<sup>®</sup>

## INSTRUCTION MANUAL

Model No.:

**RC-810A**

Please read *Instruction Manual* before use  
& Follow ALL the instructions carefully.

<b>MODEL NO.</b>	<b>RC-810A</b>
Power Consumption	350W
Voltage	220-240V
Frequency	50Hz
Volume Capacity	1.0L

## WHAT'S IN THE BOX

1. Rice Cooker – 1 set
2. Measuring cup & Spatula – 1pc
3. Power cord – 1pc
4. Instruction Manual – 1pc

## PARTS DESCRIPTION

### MAIN COMPONENT :

(Product may vary slightly from what is illustrated)

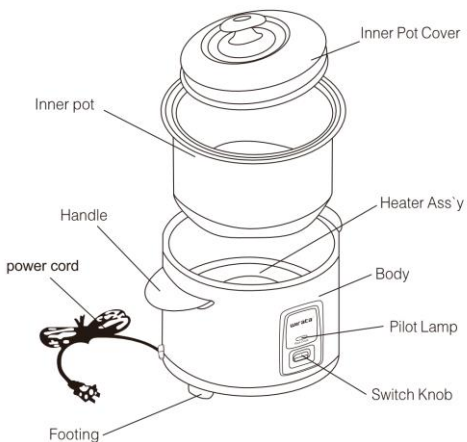

## GENERAL INSTRUCTIONS

When using the electrical appliance, the following basic safety precautions should always be followed.

Please read these instructions carefully. Pay your special attention to important safety instructions. Keep this "**Instructions for use**" for future reference.

## SAFETY INSTRUCTIONS

1. Always remove the plug from the socket whenever the device is not in use, when attaching accessory parts, cleaning the device or whenever a disturbance occurs, Switch off the device beforehand. Pull on the plug, not on the cable.
2. In order to protect children from the dangers of electrical appliances, never leave them unsupervised with the device. Consequently, when selecting the location for your device, do so in such a way that children do not have access to the device. Take care to ensure that the cable does not hang down.
3. This appliance cannot be used by the persons (including children) with reduced physical, sensory or mental capabilities, or lack of experience and knowledge, unless they have been given supervision or instruction by the person who responsible for their safety. Children should be supervised to keep away from this appliance and forbid to play with it.
4. Test the device and the cable regularly for damage. If there is damage of any kind, the device should not be used.
5. Do not repair the device yourself, but rather consult an authorised expert.
6. For safety reasons a broken or damaged mains lead may only be replaced by an equivalent lead from the manufacturer, our customer service department, or a similarly qualified person.

7. Keep the device and the cable away from heat, direct sunlight, moisture, sharp edges, and suchlike.
8. Never use the device unsupervised. Switch off the device whenever you are not using it, even if this is only for a moment.
9. Use only original accessories.
10. Do not use the device outdoors.
11. Under no circumstances must the device be placed in water or other liquid, or meet such. Do not use the device with wet or moist hands.
12. Should the device become moist or wet, remove the mains plug from the socket immediately.
13. Do not reach into the water.
14. Use the device only for the intended purpose.

**WARNING:** In case of damage to the soft wire of power, it shall be replaced with special soft wire or special parts purchased from its maker or any appointed maintenance department shops.

## PRECAUTION

Do not use inner pot directly in open flame.

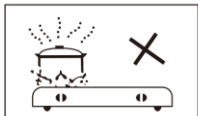

Always unplug the unit when not in use.

- Pull by the plug; never pull on the cord.



Avoid the heater plate from getting wet.



Do not attempt to repair or RECONSTRUCT the unit in case of trouble.

- Ask authorized service person for repair.



Be sure the inner pot bottom is not dented or deformed.

- Deformed, inner pot bottom can affect the cooking efficiency.

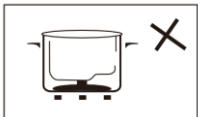

Do not use cooker for other purposes.

- The heater maybe damaged and will not function properly.

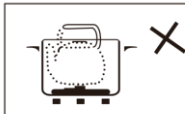

Set unit on a stable surface,

- Do not expose to water, high humidity or heat sources.



## HOW TO OPERATE

**Before using the machine for the first-time water should be boiled in it twice without any additives.**

1. Measure rice using cup provided with the unit. Then pour on the inner pot.

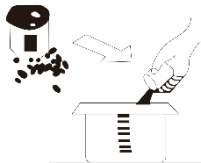

2. Wash the rice, then adjust quantity of water to desired proportion.



No. of cups of rice	1	2	3	4
No. of cups of water	1¼	2¼	3¼	4¼

- Place the inner pot directly on the heater plate. Wipe the outside surface of the inner pot with a soft dry cloth before putting it inside the body.

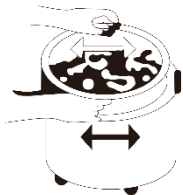

- Make sure that the inner pot is properly placed on the heater plate by turning it slightly left and right.
- Plug to 230V-60Hz outlet. Press switch knob and light indicator will transfer to "Cook."

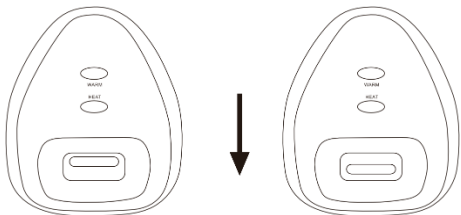

- The lamp will automatically turn "OFF" after rice cooking is finished.

**WARNING:**

DO NOT IMMERSE UNIT TO WATER.

In case of damaged power cord, please refer to service centre or ask authorized service person to repair.

## TABLE OF PROPORTION

MODEL	
RC-810A	
No.of cups of Rice	No.of cups of Water
1	1 $\frac{1}{4}$
2	2 $\frac{1}{4}$
3	3 $\frac{1}{4}$
4	4 $\frac{1}{4}$
5	5 $\frac{1}{4}$
6	6 $\frac{1}{4}$
7	7 $\frac{1}{4}$
8	8 $\frac{1}{4}$

## CLEANING INSTRUCTION

Always remove the plug from the mains supply before cleaning the machine.

1. Remove the inner pot from the unit and use clean, soft dry cloth to clean the body.

- Do not use abrasive cleaners or steel wool.

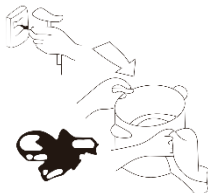



2. Clean the inner pot with detergent soap and wash completely with water.
- Then, dry the inner pot by using a soft dry cloth.

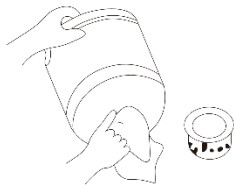

3. Use a scouring pad in removing cooked rice from the heater plate.
- Clean with non-metal brush or sponge. Do not use steel wool or steel brush to remove cooked rice inside the unit.

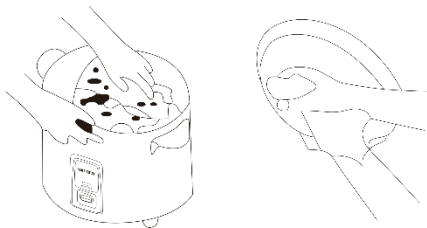

4. Always keep inner pot cover and steaming plate clean and dry.
- Use clean and dry cloth to remove dirt and stain.



#### **ENVIRONMENT PROTECTION**

Dispose the appliance according to the local garbage regulations.

Never throw it away to the rubbish, so you will help to the improvement of the environment.